

5

4

3

2

1

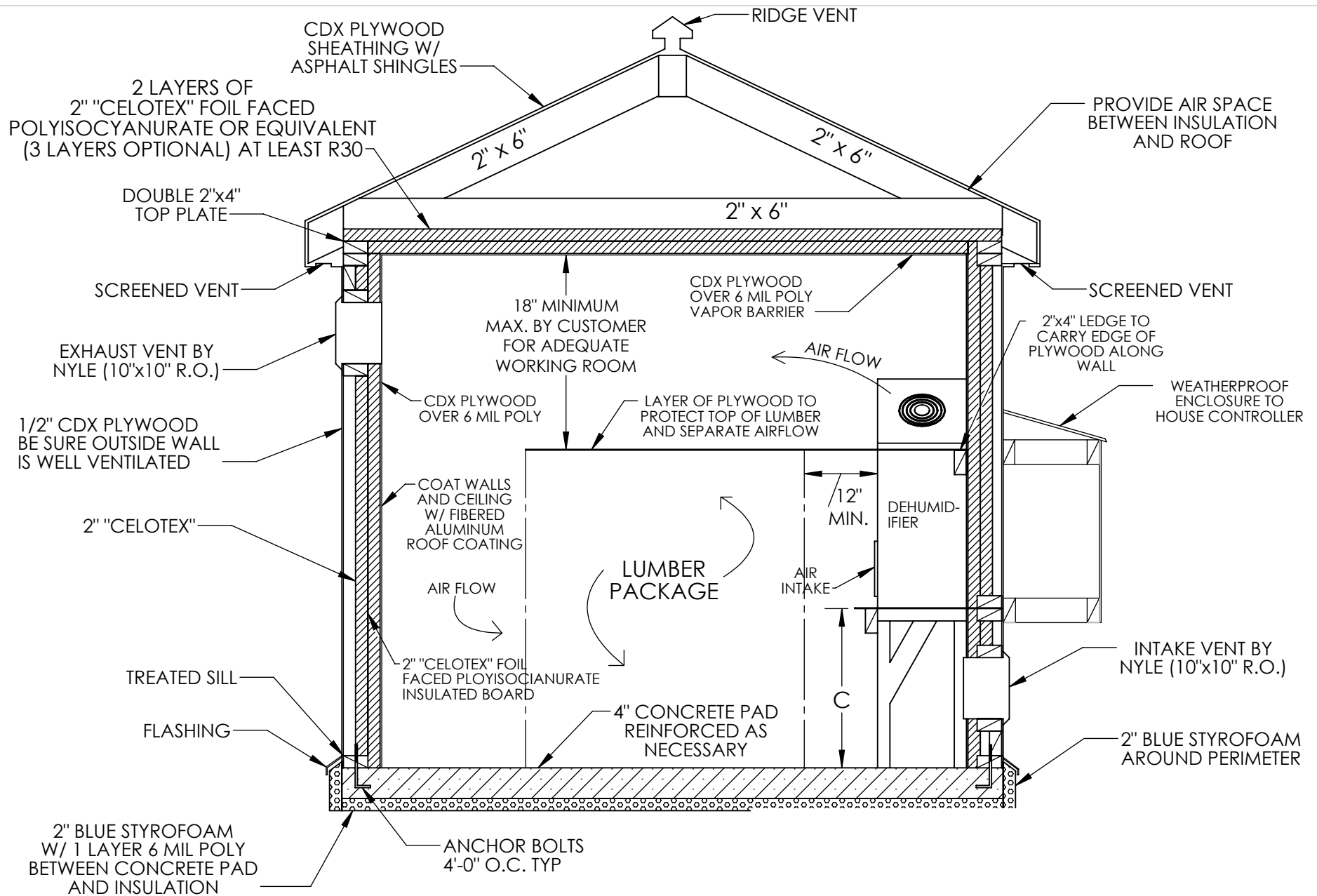

*FIBERGLASS INSULATION MAY BE USED BUT WALL INSULATION MUST HAVE AT LEAST 1-1/2" CLOSED CELL INSULATION AS INSIDE SHEATHING. THE MINIMUM R-FACTOR SHOULD BE AT LEAST R-30.

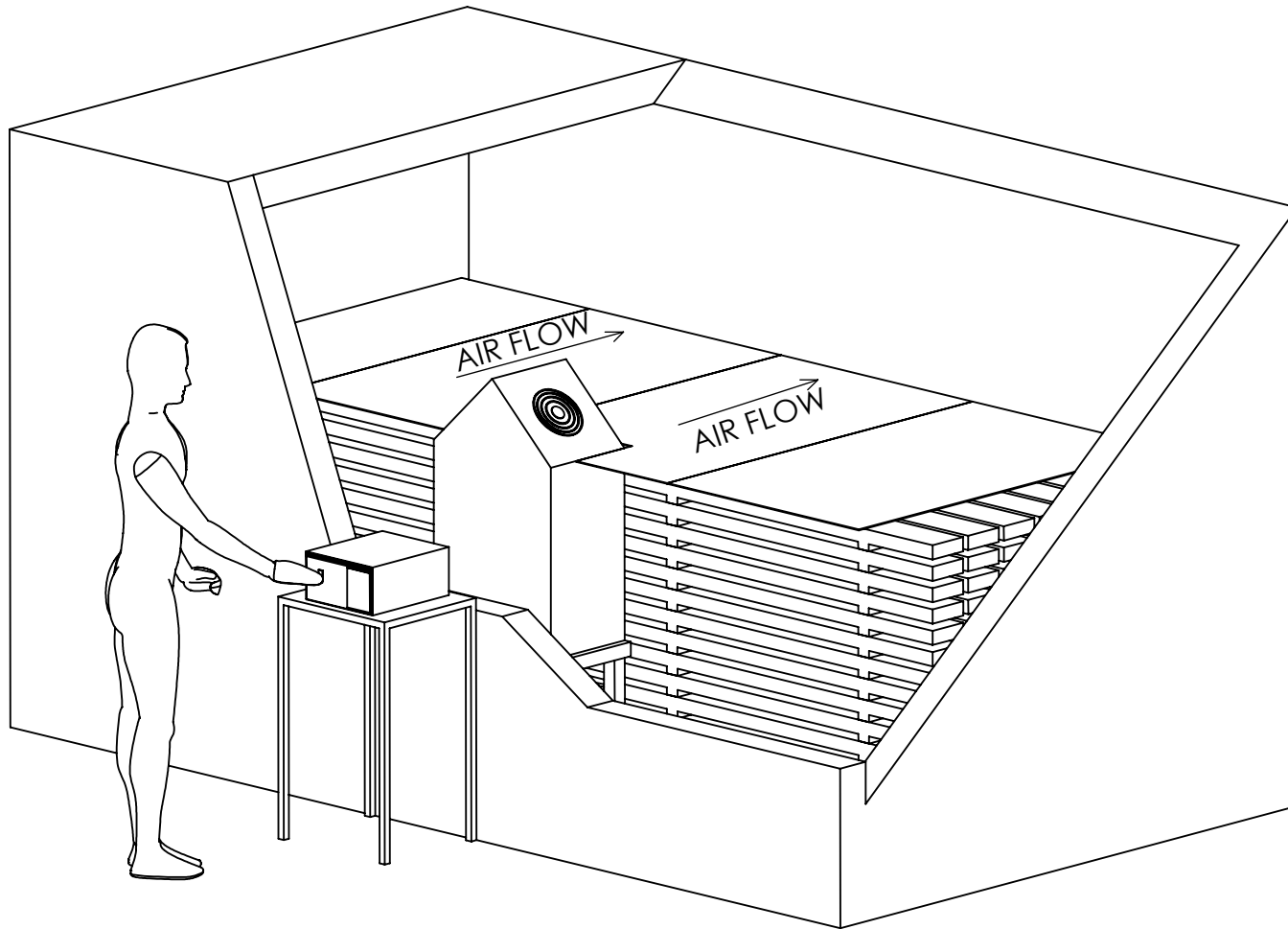

NYLE L53 LOW TEMPERATURE DEHUMIDIFICATION KILN

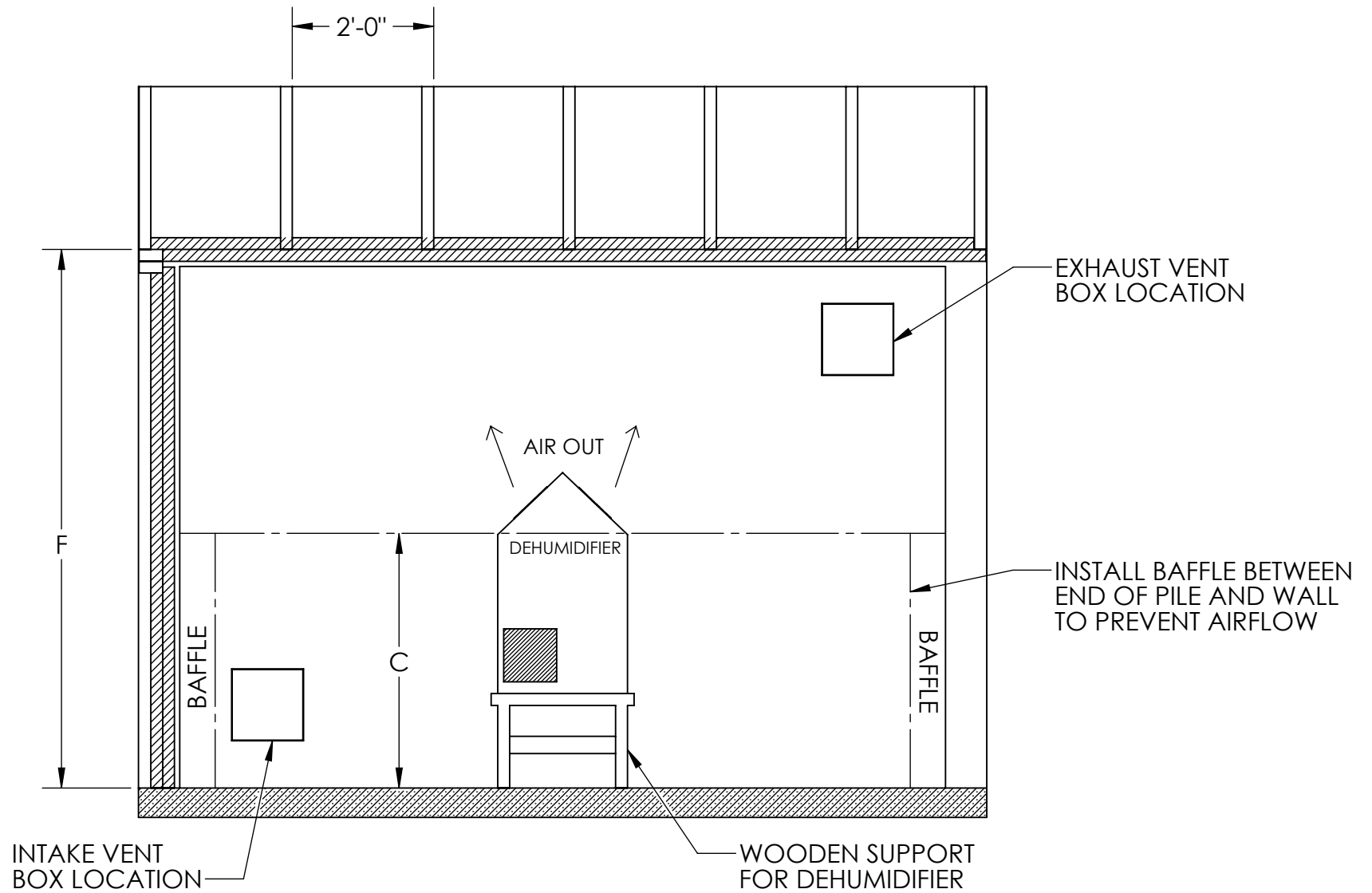

5

4

3

2

1

		8' LUMBER						12' LUMBER							
		SIZE OF PACKAGE				SIZE OF BUILDING INSIDE		SIZE OF PACKAGE				SIZE OF BUILDING INSIDE			
		LENGTH (FT)	WIDTH (FT)	HEIGHT (INCH)	NO. OF COURSES	LENGTH (FT)	WIDTH (FT)	HEIGHT (FT)	LENGTH (FT)	WIDTH (FT)	HEIGHT (INCH)	NO. OF COURSES	LENGTH (FT)	WIDTH (FT)	HEIGHT (FT)
BOARD FT.		A	B	C	D	E	F		A	B	C	D	E	F	
300		8	3	26	13	9	7	6							
500		8	3	42	21	9	7	6	12	3	28	14	13	7	6
750		8	4	46	23	9	8	6	12	3	42	21	13	7	6
1000		8	4	62	31	9	8	7	12	3	54	27	13	8	7

WIDTH DIMENSIONS ARE MINIMUM ACCEPTABLE.

COURSES BASED ON NOMINAL 1" ROUGHSAWN LUMBER ON 3/4" STICKERS.

BUILDING DIMENSIONS ARE FOR OPEN SPACE INSIDE INSULATION.